

B. Acrylic Appliances (e.g. RPE)

- a) Using a microetcher or a rotary instrument, roughen and place retention holes in the internal surfaces of the appliance.
- b) Prepare the teeth as mentioned in section #1.
- c) To facilitate removal of the appliance, place petroleum jelly on the occlusal surfaces of the teeth.
- d) Fill the internal surfaces of the appliance with mixed GC Fuji ORTHO LC PASTE PAK Automix.
- e) Seat into proper position.
- f) Immediately remove excessive cement from the periphery of the appliance.
- g) Moving the curing light tip in a distal-to-mesial direction, light-cure on the buccal, palatal and occlusal surfaces.
Halogen, LED (470 nm wavelength) : 20 seconds on each surface
GC G-Light : 10 seconds on each surface
- h) Appliance activation can begin at the patient's bedtime the same evening.

5. DEBONDING PROCEDURE

A. Brackets

Grasp the bracket with a ligature cutter and, while supporting the tooth with fingers from the lingual side, give a sharp clockwise rotation to the bracket. If resistance is met, try again twisting in the opposite direction after desiccating the tooth around the bracket (using an air syringe). Remove any residual cement with a scaler or rotary instrument.

B. Acrylic Appliances

To remove bonded appliances, flex the appliance in multiple sites with band removing pliers. If this does not remove the appliance, section the appliance, desiccate the cement, and remove the appliance.

CLEANING / STERILIZATION OF PASTE PAK DISPENSER

For cleaning and sterilization of PASTE PAK DISPENSER, refer to the respective instructions for use.

SHADE

Universal

STORAGE

Store in a cool and dark place (4 - 25°C) (39.2 - 77.0°F).

If not in use for a prolonged period of time, store in refrigerator.

(Shelf life : 2 years from date of manufacture)

PACKAGE

- 1) GC Fuji ORTHO LC PASTE PAK Automix Starter Set
Paste Pak Cartridge (13.5g / 7.2mL) (1), GC Mixing Tip For LC (20),
ORTHO GEL CONDITIONER (1.4g / 1.2mL) (2), Brush tip (15)
- 2) GC Fuji ORTHO LC PASTE PAK Automix Refill
Paste Pak Cartridge (13.5g / 7.2mL) (2), GC Mixing Tip For LC (40)
- 3) ORTHO GEL CONDITIONER
Syringe (1.4g / 1.2mL) (3), Brush tip (25)
- 4) GC Mixing Tip For LC Refill (20)
- 5) Paste Pak Dispenser (1)

CAUTION

1. In case of contact with oral tissue or skin, remove immediately with a sponge or cotton soaked in alcohol. Flush with water. To avoid contact, a rubber dam and/or cocoa butter can be used to isolate the operation field from the skin or oral tissue.
2. In case of contact with eyes, flush immediately with water and seek medical attention.
3. In rare cases metal may cause sensitivity to some people. If any such reactions are experienced, discontinue the use of Paste Pak Dispenser (nickel-plated aluminum) and refer to a physician.
4. Store Paste Pak Dispenser away from chemicals such as iodine tincture containing halogen element. Otherwise the dispenser may discolor.
5. Do not use GC Fuji ORTHO LC PASTE PAK Automix in combination with eugenol containing materials as eugenol may hinder GC Fuji ORTHO LC PASTE PAK Automix from setting or bonding properly .
6. The brush tip is disposable. The brush tip cannot be sterilized.

MANUFACTURED BY
GC CORPORATION
76-1 Hasunuma-cho, Itabashi-ku, Tokyo 174-8585, Japan

DISTRIBUTED BY
GC CORPORATION
76-1 Hasunuma-cho, Itabashi-ku, Tokyo 174-8585, Japan

GC AMERICA INC.
3737 West 127th Street, Alsip, IL 60803 U.S.A.
TEL: +1-708-597-0900

GC ASIA DENTAL PTE. LTD.
19 Loyang Way, #06-27 Singapore 508724
TEL: +65 6546 7588

PRINTED IN JAPAN

GC Fuji ORTHO LC PASTE PAK Automix

DUAL CURED REINFORCED GLASS IONOMER
ORTHODONTIC BRACKET CEMENT

Prior to use, carefully read
these instructions for use.

For use only by a dental professional in the recommended indications.

RECOMMENDED INDICATIONS

1. Bonding metal brackets and attachments.
2. Bonding ceramic brackets.
3. Bonding acrylic appliances e.g. Rapid Palatal Expander (RPE)

CONTRAINDICATIONS

1. In rare cases the product may cause sensitivity in some people. If any such reactions are experienced, discontinue the use of the product and refer to a physician.
2. Bonding polycarbonate brackets.
3. Cementation of stainless steel crown-retained appliances (e.g., Herbst Appliances).

180481 GC

IDENTIFICATION OF PARTS (Fig. 1)

- A. Paste Pak Cartridge
1. Cover 2. Inner plunger 3. Cartridge tip
- B. Paste Pak Dispenser
4. Piston 5. Adjusting guide 6. Lever
7. Sliding block 8. Piston release
- C. GC Mixing Tip For LC
9. Release tab 10. Grip 11. Guide pin

PASTE PAK CARTRIDGE LOADING

1. Make sure that the piston is completely retracted into the dispenser (Fig. 2).

NOTE:

To retract the piston, push the piston release and at the same time pull the sliding block (on the underside of the dispenser) with fingers.

2. Load the cartridge into the Paste Pak Dispenser (Fig.3). Ensure the ▲ mark on the cartridge lines up with the ▲ mark on the Paste Pak Dispenser as illustrated. Then turn the cartridge fully to the right position.

3. After cartridge loading, push the piston release forward until it stops (Fig. 4).

- a) Push the piston release forward.
b) Do not push the upper side.

NOTE:

To remove the cartridge, retract the piston fully and turn the cartridge back to the marked positions.

DIRECTIONS FOR USE

1. TOOTH PREPARATION

- a) Hold the syringe of ORTHO GEL CONDITIONER upright and remove the wing cap by turning counterclockwise. Promptly and securely attach the brush tip by turning clockwise.

- b) Clean tooth surfaces to be bonded with pumice and water. Rinse thoroughly with water.

- c) Dispense ORTHO GEL CONDITIONER directly onto the tooth surface to be bonded and leave for 10 seconds. Rinse thoroughly with water.

- d) Remove excess moisture by blotting with a cotton pellet or gently blowing with an oil-free air. DO NOT DESICCATE. Prepared surfaces should appear moist (glistening).

NOTE:

If the surface to be bonded contains porcelain, zirconium ceramic or metal, porcelain should be sandblasted and pre-treated with silane, and zirconium ceramic and metal should be sandblasted. Refer to manufacturer's instructions.

2. BRACKET PREPARATION

Make sure that the bracket is pretreated and handled according to the manufacturer's instructions.

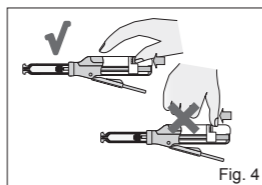
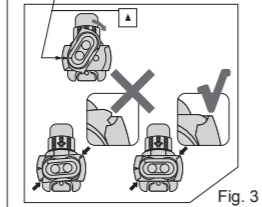
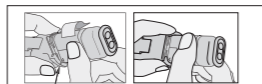
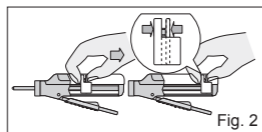
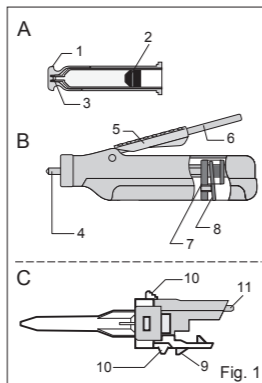

3-1. DISPENSING AND AUTOMIXING with GC Mixing Tip For LC

- a) Remove the cartridge cover.

- b) Before every use, check the two openings of the cartridge tip and confirm the pastes are at the same level to ensure even flow from the cartridge.

NOTE:

Before dispensing the first time from a new cartridge or after a long interval in between use, bleed the pastes from the cartridge.

- c) Attach the GC Mixing Tip For LC correctly on the cartridge by aligning the guide pin on the GC Mixing Tip For LC with the hole on the cartridge, simultaneously pushing the tip until it clicks on the cartridge (Fig. 5-1).

NOTE:

- 1) Make sure GC Mixing Tip For LC is securely attached to the cartridge. If not, remove the GC Mixing Tip For LC and reattach (Fig. 5-2).

- 2) If the material has been refrigerated, leave the cartridge in room temperature for 10 minutes.

- d) Set the adjusting guide to the front of the lever (Fig. 6).

NOTE:

Before dispensing the material into the appliances, bleed a small amount of the mixed paste on a pad.

- e) Slowly depress the lever to dispense the material onto the appliance.

- f) After dispensing, release the lever. To remove the GC Mixing Tip For LC, push the GC Mixing Tip For LC forward while depressing the release tab with one hand, and move the front part of the GC Mixing Tip For LC from side to side with the other hand (Fig.7). Clean the cartridge tip and replace the cartridge cover.

NOTE:

- 1) Do not leave the used GC Mixing Tip For LC on the cartridge for a long period of time.

- 2) The amount of residual material in the cartridge can be confirmed by the position of the sliding block on the underside of the dispenser. When only a small amount of paste remains in the cartridge, the paste may not be dispensed from the GC Mixing Tip For LC.

- 3) To avoid damage, do not drop the dispenser with the cartridge and mixing tip.

3-2. DISPENSING AND HANDMIXING

- a) Remove the cartridge cover.

- b) Depress the lever to dispense the required amounts of paste onto the mixing pad.

NOTE:

- 1) Before dispensing the first time from a new cartridge or after a long interval in between use, bleed the pastes from the cartridge.

- 2) The adjusting guide can be moved forwards or backwards to change the quantity of material to be dispensed (Fig. 8). Set the adjusting guide to the front of the lever for cementation of multiple brackets.

- c) Depress the lever while moving the cartridge and dispenser backward (Fig. 9). Keep

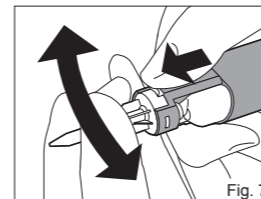
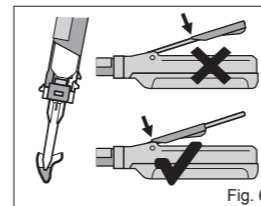
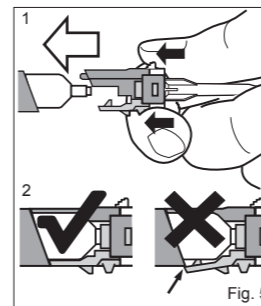

depressing the lever (Fig. 10-1) and level and cut off the extruded material from the cartridge tips by moving the cartridge and dispenser to an upright position on the mixing pad (Fig. 10-2).

- d) When the lever is released after dispensing, residual pastes at the cartridge tips are retracted into the cartridge. Clean the cartridge tip and replace the cartridge cover.

NOTE:

The amount of residual material in the cartridge can be confirmed by the position of the sliding block on the underside of the dispenser.

- e) After dispensing, spread the two pastes thinly on the mixing pad using a plastic spatula. Mix thoroughly, with lapping strokes, for 10 seconds. Be careful not to incorporate air bubbles.

NOTE:

- 1) The two pastes are similar in color, so mix with care. Larger amount of paste requires a longer mixing time (15 seconds).

- 2) Do not mix GC Fuji ORTHO LC PASTE PAK Automix with other materials.

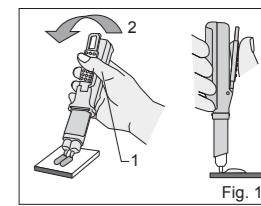
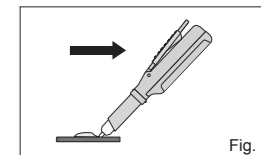
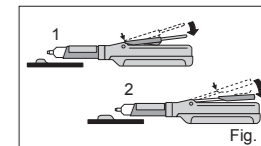

4. BONDING TECHNIQUE

A. Brackets

- a) Coat the bonding surface of the bracket with sufficient mixed cement. The working time is 5 minutes from start of mixing at 23°C (73.4°F). Higher temperature will shorten working time.

- b) Position the coated bracket on the tooth.

- c) Press the bracket firmly against the tooth surface. Using an explorer or a scaler, remove excess cement at this time. Press the bracket again. Repeat the procedure and place all brackets in a quadrant or in the full arch. If bracket drift is a concern, "tack" the brackets by light curing for approximately 5 seconds using a visible light curing unit (470 nm wavelength : Halogen, LED) or 2-3 seconds with GC G-Light.

NOTE:

After removing excess cement, be careful not to disturb the brackets until the cement is cured. Movement of the brackets at this point might decrease the bond strength.

- d) Light cure each bracket from the mesial and distal aspects using the light curing unit. Halogen, LED (470 nm wavelength) : 20 seconds from each aspect
GC G-Light : 10 seconds from each aspect

- e) Insert leveling wire and complete initial procedures. A light force wire (e.g., .016 Niti or equivalent) is recommended at the initial bonding.